

PoE Surge Protector

Installation Instructions

DT-CAT6-DIN

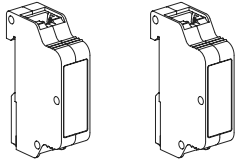

Important Notes:

- Please read this manual carefully before installing or operating the product. If you have any questions, please contact our company.
- Unauthorized disassembly of the product is strictly prohibited to prevent instrument failure or malfunctions.

Wiring

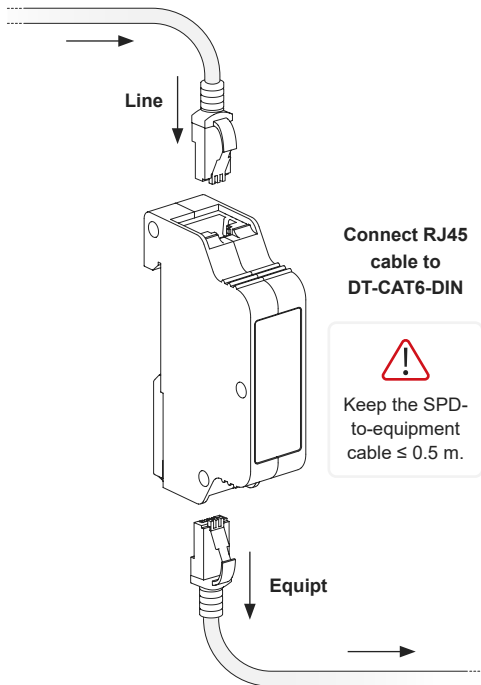

Working Conditions

	+2000 m max. -500 m min.		+80 °C max. -40 °C min.
	IP10 (built in) Indoor use only		Humidity range 20% to 80%

Characteristics

Max. continuous voltage DC	60 V
Max. continuous voltage AC	34 V
Load current I_L	1 A for 2 pairs, 2 A for 4 pairs
Nominal discharge current C2 (Total)	10 kA
Voltage Protection Level Line - Line for I_n C2	≤ 180 V
Voltage Protection Level Line - PG for I_n C2	≤ 500 V
Voltage Protection Level Line - Line for I_n C2 (PoE)	≤ 600 V

Maintenance

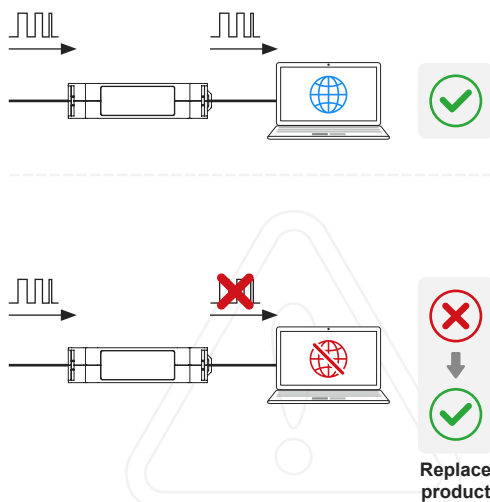

Cabinet Installation Guide

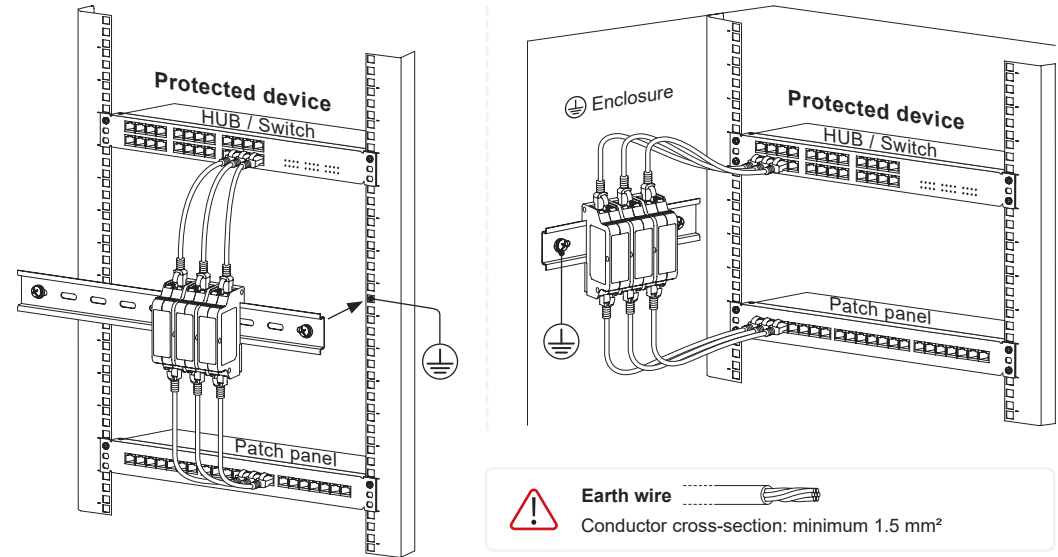

Terminal Equipment Installation Guide

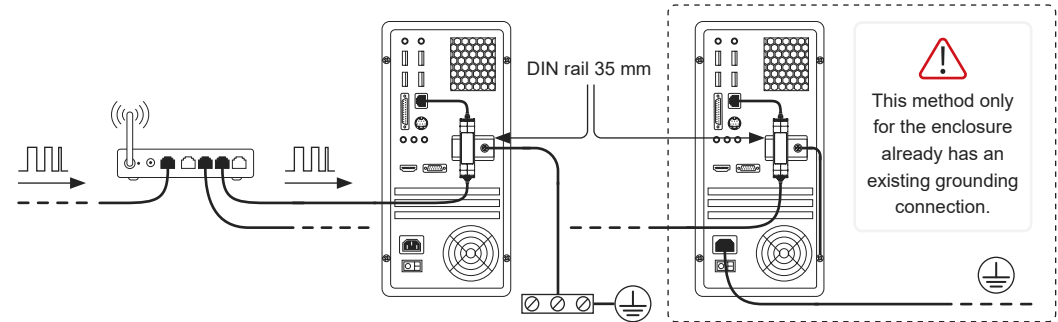

Wiring precautions

