

PoE Surge Protector DT-CAT6-DIN

Class II • Type 2



- Ideally suited for retrofitting, protection of all lines
- Cat. 6 in the channel (class E)
- Power over Ethernet IEEE 802.3 compliant (up to PoE++ / 4PPoE)
- For installation in conformity with the lightning protection zone concept at the boundaries from 0_B-2 and higher

DT-CAT6-DIN is a single-port industrial PoE surge protector designed for exterior complex backhaul and networking applications with an IP10 rated Zinc alloy shell. It supports 8 lines network signals and 10/100/1000 Mbps of data rates. Ideal for 120 W (max.) PoE wires.

Either port can be PoE in or PoE out. This model equipped standard DIN rail mounting bracket, which can easily jam into the guide rail. The DIN rail as a ground wire to transmit the current to the earth.

Technical Data

DT-CAT6-DIN

IEC Electrical

SPD according to EN 61643-21 / IEC 61643-21		Class II / Type 2
Nominal Voltage	U_n	48 V
Maximum Continuous Operating Voltage (DC)	U_C	60 V
Maximum Continuous Operating Voltage (AC)	U_C	34 V
Maximum Continuous Operating Voltage (DC) Pair - Pair (PoE)	U_C	57 V
Nominal Current	I_L	1 A for 2 pairs, 2 A for 4 pairs
D1 Lightning Impulse Current (10/350 μ s) per Line	I_{imp}	0.5 kA
C2 Nominal Discharge Current (8/20 μ s) Line - Line	I_n	150 A
C2 Nominal Discharge Current (8/20 μ s) Line - PG	I_n	2.5 kA
C2 Total Nominal Discharge Current (8/20 μ s)	I_n	10 kA
C2 Nominal Discharge Current (8/20 μ s) Pair - Pair (PoE)	I_n	150 A
Voltage Protection Level Line - Line for I_n C2	U_P	≤ 180 V
Voltage Protection Level Line - PG for I_n C2	U_P	≤ 500 V
Voltage Protection Level Line - Line for I_n C2 (PoE)	U_P	≤ 600 V
Voltage Protection Level Line - Line at 1 kV/ μ s C3	U_P	≤ 180 V
Voltage Protection Level Line - PG at 1 kV/ μ s C3	U_P	≤ 500 V
Voltage Protection Level Pair - Pair at 1 kV/ μ s C3 (PoE)	U_P	≤ 600 V
Maximum Operating Power		120 W
Data Speed		10/100/1000 Mbps
Cut-Off Frequency	F_G	250 MHz
Insertion Loss at 250 MHz		≤ 3 dB
Capacitance Line - Line	C	≤ 30 pF
Capacitance Line - PG	C	≤ 25 pF
Operating Temperature Range	T_u	-40°C to +80°C
Operating Humidity		20% to 80%, non-condensation
Degree of Protection		IP10
For Mounting on		35 mm DIN rails acc. to EN 60715
Connection (Input / Output)		RJ45 / RJ45
Earthing via		DIN rail as a ground wire
Pinning		1 / 2, 3 / 6, 4 / 5, 7 / 8
Enclosure Material		Zinc alloy case
Color		Grey



Order Information

Ordering Code	60
DT-CAT6-DIN	0104860

DT-CAT6-DIN

Internal Configuration

Legend

-  PE/G Conductor Terminal
-  DB Diode Block
-  GDT Gas Discharge Tube

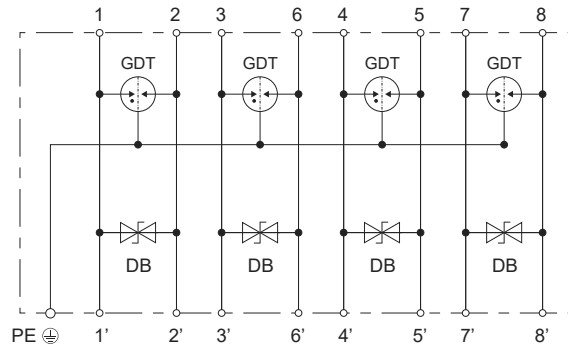

Dimensions & Packaging

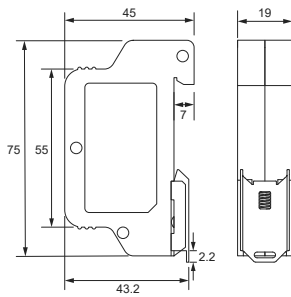

[mm]

Complete Unit	
DT-CAT6-DIN	60 Vdc
Net Weight	115 g
Packaging Dimensions (Single Unit)	[83 × 49 × 25 mm]
Packaging Dimensions (H x W x L)	[340 × 305 × 210 mm]
Standards Order Quantity	100 Units

Easy installation instructions

